

Power Range
600W



Power Tolerance
0W ~ +5W



Maximum Efficiency
21.4%

Features and Benefits



The application of multi-busbar (MBB) half-cut cell technology brings stronger resistance to shade and lower risk of hot spot.



Strict control on raw materials and process optimization of high efficiency PERC ensure better resistance against PID of PV



Through harsh weathering tests of sand, dust, salt mist, ammonia, etc., to get stronger weather resistance of outdoor environment.



Lower oxygen and carbon content result in lower LID.module.



By series and parallel design, to reduce the series RS and achieve higher power output and lower BOS cost.



Lower temperature coefficient and lower operating temperature can ensure higher power generation.

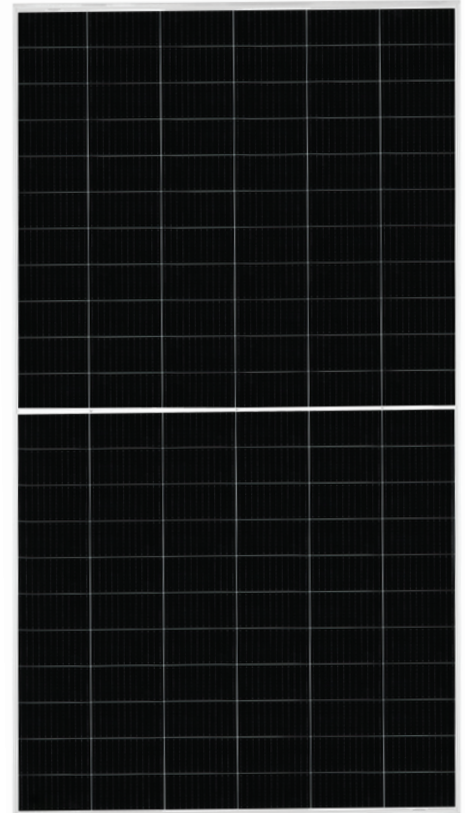

*Product Certificates

IEC 61215 / IEC 61730: VDE / CE / MCS / KS / INMETRO
IEC 61701 ED2: VDE / IEC 62716: VDE
UNI 9177 Reaction to Fire: Class 1 / Take-e-way



* As there are different certification requirements in different markets, please contact your local CarbonFree sales representative for the specific certificates applicable to the products in the region in which the products are to be used.

First-Class Warranty



12 Years product workmanship warranty



1st year power degradation no more than **2%**.
Subsequent annual power degradation no more than **0.55%**.



25 year linear power output warranty



Electric Performance Parameters | STC

Nominal Max. Power	P _{max} (W)	585	590	595	600	605
Maximum Power Voltage	V _{mp} (V)	33.70	33.90	34.10	34.30	34.50
Maximum Power Current	I _{mp} (A)	17.36	17.41	17.45	17.50	17.54
Open Circuit Current	V _{oc} (V)	40.80	41.00	41.20	41.40	41.60
Short Circuit Current	I _{sc} (A)	18.36	18.40	18.44	18.48	18.56
Module Efficiency	(%)	20.70	20.80	21.00	21.20	21.40
Power Tolerance	(W)	0~+5W				

*STC : Irradiance 1000 W/m², Cell Temperature 25°C, Air Mass AM1.5.

*Power measurement tolerance ± 3%.

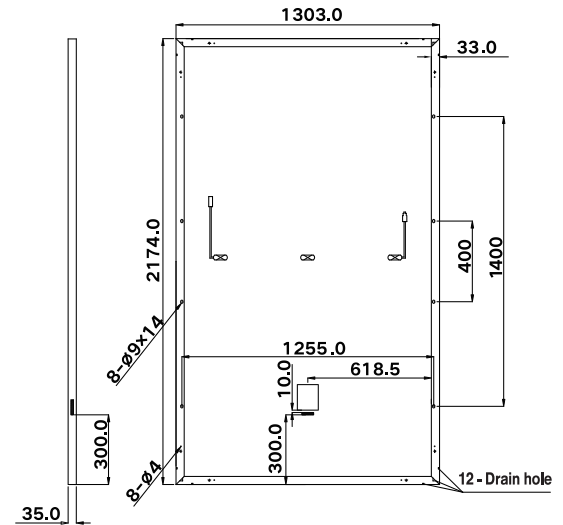

Electric Performance Parameters | NMOT

Model Type		585D(HPM) 60(210)	590D(HPM) 60(210)	595D(HPM) 60(210)	600D(HPM) 60(210)	605D(HPM) 60(210)
Nominal Max. Power	V _{mp} (V)	443	447	451	454	458
Maximum Power Voltage	V _{mp} (V)	31.54	31.73	31.92	32.02	32.21
Maximum Power Current	I _{mp} (A)	14.05	14.09	14.13	14.18	14.22
Open Circuit Voltage	V _{oc} (V)	38.50	38.70	38.90	39.10	39.30
Short Circuit Current	I _{sc} (A)	14.81	14.85	14.89	14.93	14.97

*NMOT : Irradiance 800 W/m², Cell Temperature 20°C, Wind Speed 1 m/s.

*Power measurement tolerance ± 3%.

Structure Performance

Solar Cell Type	210mm Mono - Crystalline (Half Cell)
Solar Cell Arrangement	120pcs (6x20)
Module Dimension	2174 x 1303 x 35mm
Weight	31.2 kg
Front Glass	3.2mm, highly transparent tempered glass with anti-reflective coating
Backsheet	White
Frame	Anodized Aluminum Alloy
Junction Box	IP68 Rated
Cable	4mm ² PV Cable, 300mm or Customized Length
Diode Quantity	3 Pcs
Front Side / Rear Side	5400 pa / 2400 pa
Connector	MC4 Compatible
Per Pallet	31 Pcs
Per Container (40'HQ)	558 Pcs

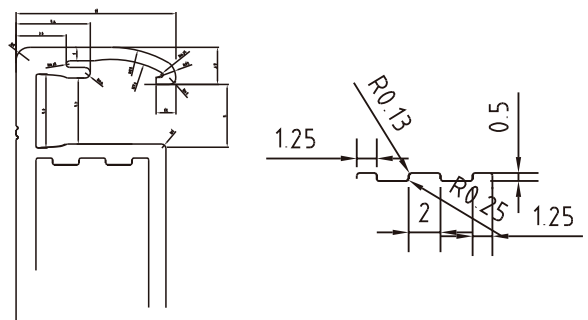

Temperature Characteristics

Nominal Module Operating Temp.	44±2°C
Temp. Coefficient (I _{sc})	+0.07%
Temp. Coefficient (V _{sc})	-0.36%
Temp. Coefficient (P _{max})	-0.38%

Maximum Parameters

Working Temperature	-40~+70°C
Maximum System Voltage	1500V DC
Normal Max. Fuse Current	30A